

## RADIO CONTROL SITE RULES

- 1) The **AMA Safety Code** is in effect at ALL TIMES.
- 2) **Special rules** may exist for certain scheduled events.
- 3) All radio controlled powered flights must take place from the Stage Center
- 4) All pilots must fly from one of the designated pilot stations.
- 5) Pilots and helpers only beyond the designated pit line.
- 6) All aircraft **MUST REMAIN CLEAR OF RESTRICTED AREAS** as posted at flying site.
- 7) All **radio controlled power flights** must take place north of the flight line.
- 8) All **Soaring** or non-runway oriented radio controlled flights shall fly south of the runway flight line.
- 9) The **frequency board** will be used at all times.
- 10) **All transmitters** will carry AMA recommended channel number systems.
- 11) **It is strongly recommended that you not fly alone.**
- 12) **In case of emergency**, use pavilion phone and dial 911. Notify AMA HQ (287-1256), if during business hours.
- 13) Open flying restricted during scheduled events. (Watch for posted signs.)
- 14) Absolutely no vehicles on the runway.
- 15) All vehicles must be moved to gravel parking lots or designated area after unloading.
- 16) Dogs must be on a leash at all times.

### Medical Facilities:

Doctor's Immediate MedCenter 3025 N. Oakwood Muncie, IN 47302 286-0862 8 AM to 8 PM	Ball Memorial Hospital 2401 University Ave. Muncie, IN 47304 747-3111 ER 747-3241
--	--

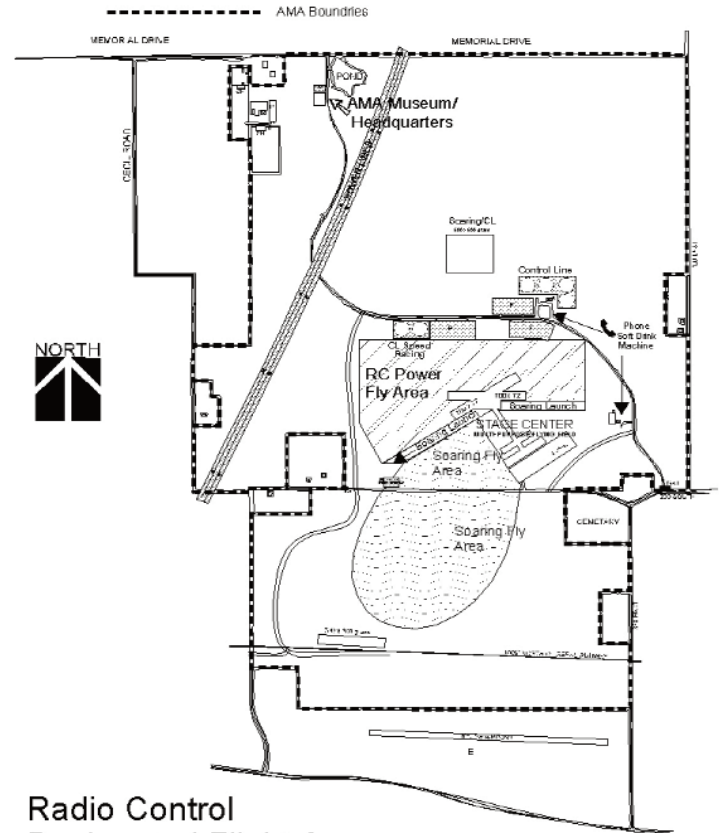

Radio Control  
Designated Flight Area

## GENERAL SITE RULES

- 1) Participants in any model operation will not consume **alcoholic beverages** prior to, or during activities.
- 2) AMA members and their guest may use the pond for **fishing** (catch and release only).
- 3) **Model boating** is only permitted on 75 MHz.
- 4) **Guests** with AMA members are provided the same privileges (except for model flying and Museum access) as though they were members. The AMA member is responsible for their guest's conduct.
- 5) **RV and tent camping** is allowed in the designated area.
- 6) **General Operations:** Office Hours 8 AM 5 PM Monday through Friday; Museum open Monday through Friday 8 AM 4:30 PM; Saturday and Sunday 10 AM to 4 PM; Site usage 8 AM to Sunset, seven days a week.
- 7) **Scheduled events** will operate between 8 AM and 5 PM with open flying 5 PM to sunset. Exceptions may be granted for certain events.
- 8) **After hours use** (non-flying) of the site will observe a 10 PM "QUIET TIME." After hours use is allowed so long as it does not disrupt other site activities, cause harm or damage to the facility or surrounding property.
- 9) **Motorbikes, automobiles and offroad vehicles** are prohibited from operating on improved flying areas (runways, control line circles and improved grassed areas) **UNLESS** the operator is retrieving a model aircraft **AND** alternative routes are not readily available.
- 10) **Motor vehicles** are not allowed to operate on the site after sunset without an operational front and tail light.
- 11) **Emergency phone numbers:** 911 County Police 747-7885. If there is an accident, on site, during normal business hours, please notify AMA HQ. During off hours there is a site representative on duty (phone 765-749-9210) or pick up phone located at the entrance shack which has direct access to the site representative.
- 12) Obey posted automobile **speed limits**.
- 13) All vehicles must be **moved to gravel parking lots** or designated area after unloading.
- 14) **Do not drive** on grass unless designated to do so.
- 15) **Failure to obey rules** can result in loss of flying privileges.
- 16) Please **pick up all litter**.
- 17) **It is strongly recommended that you not fly alone.**
- 18) **Engine operations** between 8 AM and sunset only.
- 19) **Engine sound levels** limited to 98 dB at 9 feet. (Periodic checks will be made). Sound level and operational waivers may be applied for in advance at AMA Headquarters.
- 20) **Model aircraft flying** shall only be done at the area designated for the specified use.
- 21) **Members and Guests** shall conduct themselves in a civil and sportsmanlike manner at all times.
- 22) Dogs must be on a leash at all times.

## FREE FLIGHT SITE RULES

- 1) The **AMA Safety Code** is in effect at ALL TIMES.
- 2) **Special rules** may exist for certain scheduled events.
- 3) All flights must originate from the Free Flight designated area. **DO NOT FLY FROM NO FLIGHT AREAS.**
- 4) Every effort must be made to **terminate flights on AMA property.**
- 5) **Landowners must be contacted** prior to recovering an aircraft off AMA property.
- 6) All aircraft must remain clear of restricted areas as posted at pavilion and/or Stage Center flying sites.
- 7) Please make every effort to keep aircraft clear of other areas of flight operations.
- 8) **In case of emergency**, use pavilion phone and dial 911. Notify AMA HQ (287-1256), if during business hours.
- 9) **Open flying restricted** during scheduled events. (Watch for posted signs.)
- 10) All vehicles must remain in designated parking areas, **no parking on grass** unless designated so.
- 11) **It is strongly recommended that you not fly alone.**

### Medical Facilities:

Doctor's Immediate MedCenter 3025 N. Oakwood Muncie, IN 47302 286-0862 8 AM to 8 PM	Ball Memorial Hospital 2401 University Ave. Muncie, IN 47304 747-3111 ER 747-3241
--	--

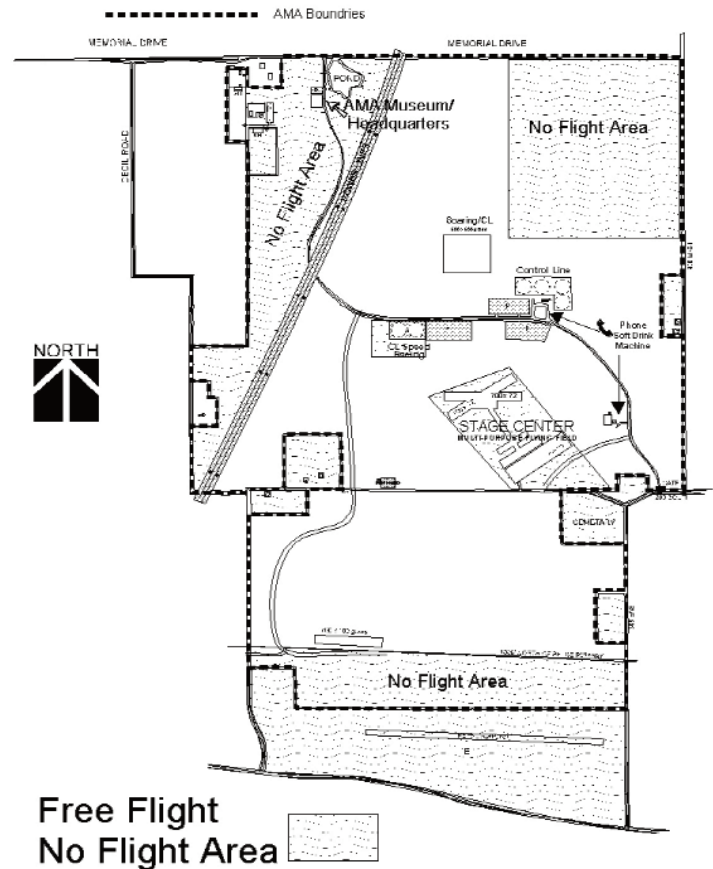

## GENERAL SITE RULES

- 1) Participants in any model operation will not consume **alcoholic beverages** prior to, or during activities.
- 2) AMA members and their guest may use the pond for **fishing** (catch and release only).
- 3) **Model boating** is only permitted on 75 MHz.
- 4) **Guests** with AMA members are provided the same privileges (except for model flying and Museum access) as though they were members. The AMA member is responsible for their guest's conduct.
- 5) **RV and tent camping** is allowed in the designated area.
- 6) **General Operations:** Office Hours 8 AM 5 PM Monday through Friday; Museum open Monday through Friday 8 AM 4:30 PM; Saturday and Sunday 10 AM to 4 PM; Site usage 8 AM to Sunset, seven days a week.
- 7) **Scheduled events** will operate between 8 AM and 5 PM with open flying 5 PM to sunset. Exceptions may be granted for certain events.
- 8) **After hours use** (non-flying) of the site will observe a 10 PM "QUIET TIME." After hours use is allowed so long as it does not disrupt other site activities, cause harm or damage to the facility or surrounding property.
- 9) **Motorbikes, automobiles and offroad vehicles** are prohibited from operating on improved flying areas (runways, control line circles and improved grassed areas) **UNLESS** the operator is retrieving a model aircraft AND alternative routes are not readily available.
- 10) **Motor vehicles** are not allowed to operate on the site after sunset without an operational front and tail light.
- 11) **Emergency phone numbers:** 911 County Police 747-7885. If there is an accident, on site, during normal business hours, please notify AMA HQ. During off hours there is a site representative on duty (phone 765-749-9210) or pick up phone located at the entrance shack which has direct access to the site representative.
- 12) Obey posted automobile **speed limits**.
- 13) All vehicles must be **moved to gravel parking lots** or designated area after unloading.
- 14) **Do not drive** on grass unless designated to do so.
- 15) **Failure to obey rules** can result in loss of flying privileges.
- 16) Please **pick up all litter**.
- 17) **It is strongly recommended that you not fly alone.**
- 18) **Engine operations** between 8 AM and sunset only.
- 19) **Engine sound levels** limited to 98 dB at 9 feet. (Periodic checks will be made). Sound level and operational waivers may be applied for in advance at AMA Headquarters.
- 20) **Model aircraft flying** shall only be done at the area designated for the specified use.
- 21) **Members and Guests** shall conduct themselves in a civil and sportsmanlike manner at all times.
- 22) Dogs must be on a leash at all times.

## CONTROL LINE FLIGHT RULES

- 1) The **AMA Safety Code** is in effect at ALL TIMES.
- 2) Fly only the aircraft designated for the specified venue. Fly in the designated circle area only. Sport flying at the Pavilion is for all control line except Speed and Team Racing which have their own venue.
- 3) There will be **NO driving** on the designated flying surface.
- 4) **Pit** in designated areas only.
- 5) **Only the pilot and mechanic** are allowed within the 80' safety circle. If no circle exists, it is the pilot's obligation to identify the safety area that shall be **NO closer than 100'** from the center of the flight circle.
- 6) The Pavilion Circle drive and gate area are for loading and **unloading only**.
- 7) **All vehicles** must be parked in the gravel parking lot. There is **NO parking** on the grass.
- 8) **Special rules** may exist for certain scheduled events.
- 9) **It is strongly recommended that you not fly alone.**

### Medical Facilities:

Doctor's Immediate MedCenter	Ball Memorial Hospital
3025 N. Oakwood	2401 University Ave.
Muncie, IN 47302	Muncie, IN 47304
286-0862 8 AM to 8 PM	747-3111-ER 747-3241

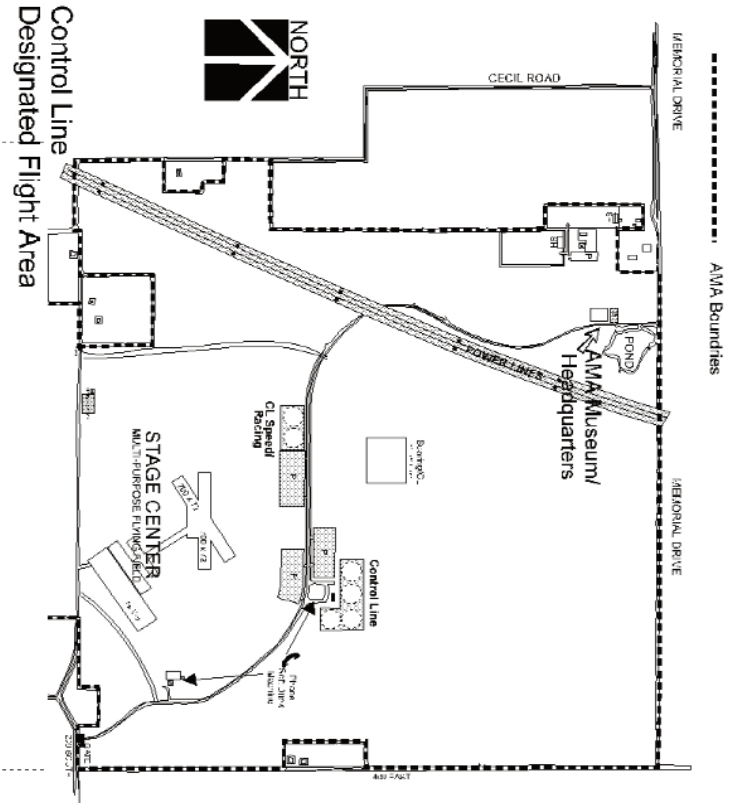

## GENERAL SITE RULES

- 1) Participants in any model operation will not consume **alcoholic beverages** prior to, or during activities.
- 2) AMA members and their guest may use the pond for **fishing** (catch and release only).
- 3) **Model boating** is only permitted on 75 MHz.
- 4) **Guests** with AMA members are provided the same privileges (except for model flying and Museum access) as though they were members. The AMA member is responsible for their guest's conduct.
- 5) **RV and tent camping** is allowed in the designated area.
- 6) **General Operations:** Office Hours 8 AM 5 PM  
Monday through Friday: Museum open Monday through Friday 8 AM 4:30 PM; Saturday and Sunday 10 AM to 4 PM; Site usage 8 AM to Sunset, seven days a week.
- 7) **Scheduled events** will operate between 8 AM and 5 PM with open flying 5 PM to sunset. Exceptions may be granted for certain events.
- 8) **After hours use** (non-flying) of the site will observe a 10 PM "QUIET TIME." After hours use is allowed so long as it does not disrupt other site activities, cause harm or damage to the facility or surrounding property.
- 9) **Motorbikes, automobiles and offroad vehicles** are prohibited from operating on improved flying areas (runways, control line circles and improved grassed areas) UNLESS the operator is retrieving a model aircraft AND alternative routes are not readily available.
- 10) **Motor vehicles** are not allowed to operate on the site after sunset without an operational front and tail light.
- 11) **Emergency phone numbers:** 911 County Police 747-7885. If there is an accident, on site, during normal business hours, please notify AMA HQ. During off hours there is a site representative on duty (phone 765-749-9210) or pick up phone located at the entrance shack which has direct access to the site representative.
- 12) Obey posted automobile **speed limits**.
- 13) All vehicles must be **moved to gravel parking lots** or designated area after unloading.
- 14) **Do not drive** on grass unless designated to do so.
- 15) **Failure to obey rules** can result in loss of flying privileges.
- 16) Please **pick up all litter**.
- 17) **It is strongly recommended that you not fly alone.**
- 18) **Engine operations** between 8 AM and sunset only.
- 19) **Engine sound levels** limited to 98 dB at 9 feet. (Periodic checks will be made). Sound level and operational waivers may be applied for in advance at AMA Headquarters.
- 20) **Model aircraft flying** shall only be done at the area designated for the specified use.
- 21) **Members and Guests** shall conduct themselves in a civil and sportsmanlike manner at all times.
- 22) Dogs must be on a leash at all times.

## INSTRUCTIONS FOR CAMPERS

- 1) **Camping is limited** to AMA members and their guests.
- 2) During certain functions showers and restrooms (other than Porta Johns) may be available at the main building. Check in advance to confirm.
- 3) **Campers** must fill out the camping form with name/address etc.
- 4) A **\$10 fee is charged** for a key deposit. This fee will be refunded when the key is returned. Should you leave when the gate is unattended, please mail your key back to AMA and request a refund.
- 5) **RV camping is allowed** in a designated parking lot; tent campers should locate themselves in the picnic area.
- 6) **Camping passes** will be issued with the date that you will be leaving. Please leave the pass in the vehicle windshield clearly visible to security to avoid being disturbed.
- 7) There is a **site representative on duty until 10 PM**. Your key is to be used after hours for your convenience. Remember, the key opens the guard shack so you can press the button to open the gate. When you leave, Please be sure that the guard shack door is locked!
- 8) A pay phone is located at the pavilion for your convenience.
- 9) **Motorhomes and RV's** shall be self contained. There are no hookups on site.
- 10) **Users are not allowed to connect to AMA utilities.**
- 11) **RV dumping** is available at:  
GMC Truck Sales, 4300 N. Broadway - 289-4481  
T & H RV Sales & Service, 2303 S. Elm (16th and Elm) - 289-9704

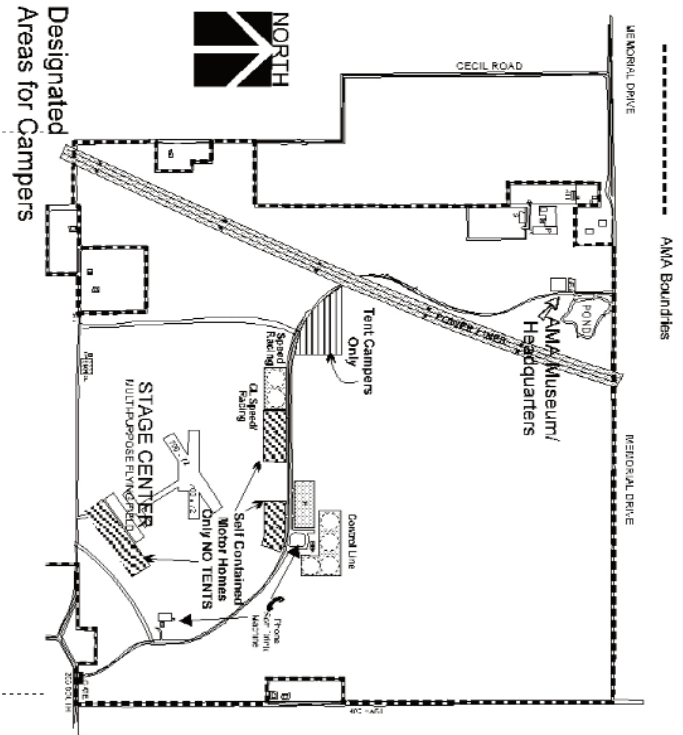

### Medical Facilities:

Doctor's Immediate MedCenter	Ball Memorial Hospital
3025 N. Oakwood	2401 University Ave.
Muncie, IN 47302	Muncie, IN 47304
286-0862 8 AM to 8 PM	747-3111 ER 747-3241

## GENERAL SITE RULES

- 1) Participants in any model operation will not consume **alcoholic beverages** prior to, or during activities.
- 2) AMA members and their guest may use the pond for **fishing** (catch and release only).
- 3) **Model boating** is only permitted on 75 MHz.
- 4) **Guests** with AMA members are provided the same privileges (except for model flying and Museum access) as though they were members. The AMA member is responsible for their guest's conduct.
- 5) **RV and tent camping** is allowed in the designated area.
- 6) **General Operations:** Office Hours 8 AM 5 PM Monday through Friday; Museum open Monday through Friday 8 AM 4:30 PM; Saturday and Sunday 10 AM to 4 PM; Site usage 8 AM to Sunset, seven days a week.
- 7) **Scheduled events** will operate between 8 AM and 5 PM with open flying 5 PM to sunset. Exceptions may be granted for certain events.
- 8) **After hours use** (non-flying) of the site will observe a 10 PM "QUIET TIME." After hours use is allowed so long as it does not disrupt other site activities, cause harm or damage to the facility or surrounding property.
- 9) **Motorbikes, automobiles and offroad vehicles** are prohibited from operating on improved flying areas (runways, control line circles and improved grassed areas) UNLESS the operator is retrieving a model aircraft AND alternative routes are not readily available.
- 10) **Motor vehicles** are not allowed to operate on the site after sunset without an operational front and tail light.
- 11) **Emergency phone numbers:** 911 County Police 747-7885. If there is an accident, on site, during normal business hours, please notify AMA HQ. During off hours there is a site representative on duty (phone 765-749-9210) or pick up phone located at the entrance shack which has direct access to the site representative.
- 12) Obey posted automobile **speed limits**.
- 13) All vehicles must be **moved to gravel parking lots** or designated area after unloading.
- 14) **Do not drive** on grass unless designated to do so.
- 15) **Failure to obey rules** can result in loss of flying privileges.
- 16) Please **pick up all litter**.
- 17) **It is strongly recommended that you not fly alone.**
- 18) **Engine operations** between 8 AM and sunset only.
- 19) **Engine sound levels** limited to 98 dB at 9 feet. (Periodic checks will be made). Sound level and operational waivers may be applied for in advance at AMA Headquarters.
- 20) **Model aircraft flying** shall only be done at the area designated for the specified use.
- 21) **Members and Guests** shall conduct themselves in a civil and sportsmanlike manner at all times.
- 22) Dogs must be on a leash at all times.